

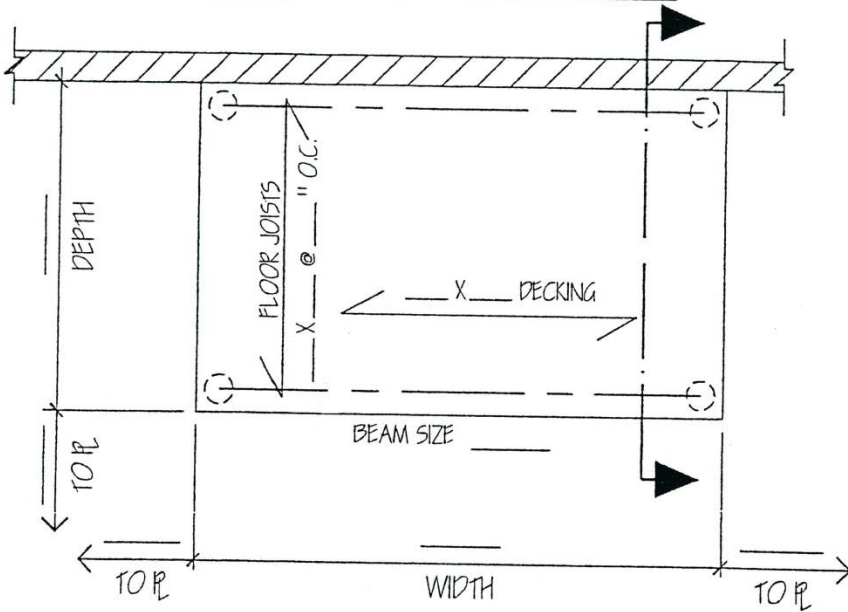

FLOATING DECK
(ONE DWELLING UNIT ONLY)

Name: _____ Building Permit No.: _____
 Address: _____ Reviewed by: _____
 Date: _____ Date Reviewed: _____

FLOATING DECK CONSTRUCTION



FLOOR PLAN

* INDICATE STAIR LOCATION

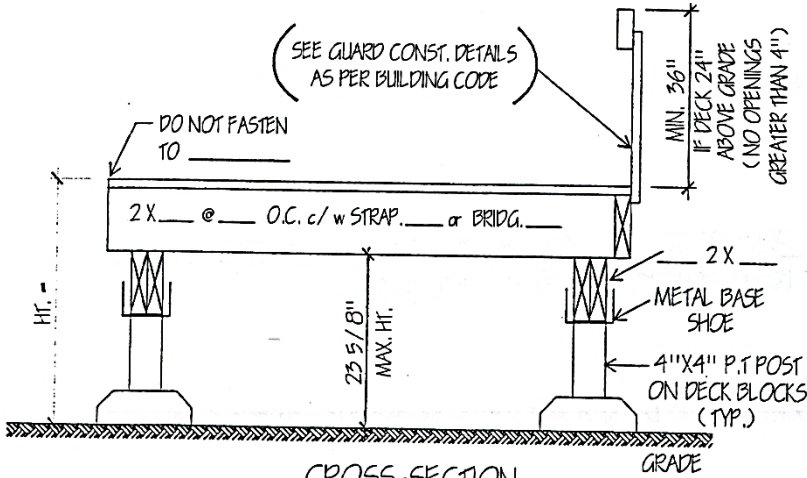

CROSS-SECTION

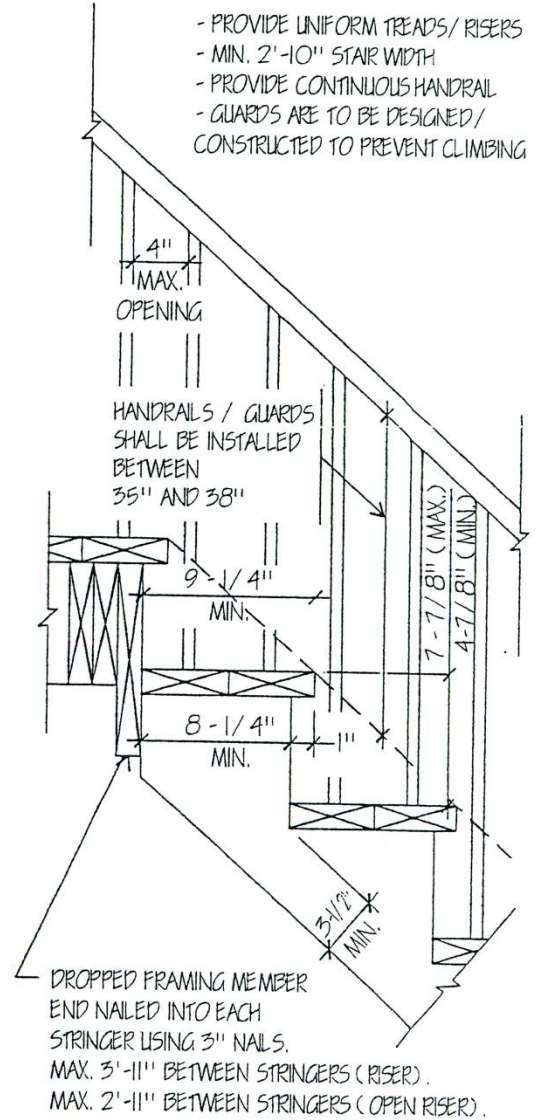

STAIR DETAIL
Not to Scale

REFER TO OTHER SIDE OF PAGE FOR BEAM / JOIST SPAN TABLES AND OTHER PERTINENT INFORMATION.

I, _____, hereby agree to construct the deck in accordance with the supplied information

(PRINT NAME)

noted above.

Signature: _____ Date: _____
 (OWNER / APPLICANT)

*Refer to other side for further information.



BEAM SPANS FOR DECKS

(ONE FLOOR LOAD)

- (2) 2x6.....5'-5" (1.66M)
- (2) 2x8.....6'-8" (2.02M)
- (2) 2x10.....8'-1" (2.47M)
- (2) 2x12.....9'-5" (2.87M)

- (3) 2x8.....9'-4" (2.85M)
- (3) 2x10.....11'-6" (3.52M)
- (3) 2x12.....13'-5" (4.09M)

- (4) 2x8.....10'-3" (3.14M)
- (4) 2x10.....13'-1" (4.01M)
- (4) 2x12.....15'-5" (4.72M)

BASED ON SPRUCE LUMBER: NO 1 & 2 GRADE

BUILT-UP BEAM SPANS PER TABLE A-8 BUILDING CODE 2006 (REVISED: MARCH 2007)

FLOOR JOIST SPANS FOR DECKS

- 2x8@12".....11'-7" (3.54M)
- 2x8@16".....11'-0" (3.36M)
- 2x8@24".....10'-6" (3.20M)

- 2x10@12".....13'-8" (4.17M)
- 2x10@16".....13'-0" (3.96M)
- 2x10@24".....12'-4" (3.77M)

BASED ON SPRUCE LUMBER: NO. 1 & 2 GRADE
(NO BRIDGING OR STRAPPING)

**FOR OFFICIAL BEAM AND JOIST SPANS, CONSULT THE LATEST
EDITION OF THE ONTARIO BUILDING CODE**

JOIST SPANS PER TABLE A-1 BUILDING CODE 2006 (REVISED: MARCH 2007)

ADDITIONAL PERTINENT INFORMATION:

- 1) Indicate the following on the floor plan:
 - a) Pier support locations
 - b) Stair location(s) and width
 - c) Deck framing
 - i) Beam size, joist size including spacing
- 2) Do not cantilever beam(s).
- 3) If floating deck does not conform to ALL of the following requirements (as per Article 9.12.2.2 (7) of the 2012 Building Code) the deck must be frost protected (piers / footings).

Article 9.12.2.2

- (7) The foundation depths required in sentence (1) do not apply to foundations for decks and other accessible exterior platforms
- a) that are not of more than 1 storey,
 - b) that are not more than 55m² (592ft²) in area,
 - c) where the distance from the finished ground to the underside of the floor joists is not more than 600 mm (23 5/8"),
 - d) that are not supporting a roof, and
 - e) that are not attached to another structure, unless it can be demonstrated that differential movement will not adversely affect the performance of that structure.