



Zoning By-law No. 39-2000  
Township of

**North Glengarry**

Lochiel

**Schedule I**

Scale 1:5000

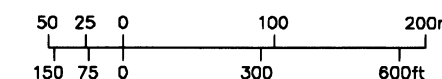

**Zone Classifications:**

Residential Hamlet	<b>RH</b>
General Commercial	<b>CG</b>
Local Commercial	<b>CL</b>
Highway Commercial	<b>CH</b>
Institutional	<b>IN</b>
Open Space	<b>OS</b>
General Industrial	<b>MG</b>
Waste Disposal	<b>WD</b>
Flood Plain	<b>FP</b>
Exception	<b>-numeral</b>
Holding	<b>-h</b>

**Legend:**

Sub-Schedule Boundary	
Roads	
Legal Fabric	
Railway	
Zone Boundary	

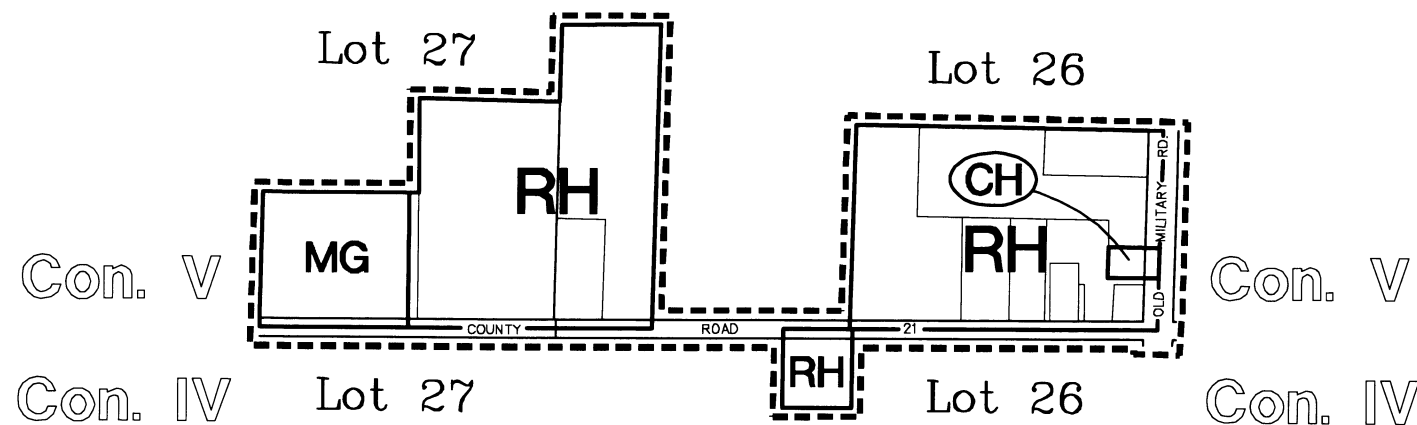

Office Consolidation: 15/08/02  
Office Consolidation: 12/12/06  
Office Consolidation: 12/31/09  
Office Consolidation: 09/03/13

**Certificate of Authentication**

This is Schedule '1' to By-law No. **39-2000**, passed this **14th** day of **August**, 2000.

**GRANT CRACK** Mayor      **LEO POIRIER** Clerk



P:\16000\16975-2B Zoning Consolidation\JLR DWG\Plan\Zoning By-law\Hamlet\_zoning\lochiel\_surround.dwg